



NOTE: A DETAILED LANDSCAPING PLAN SHALL BE SUBMITTED 90 DAYS PRIOR TO ISSUANCE OF A BUILDING PERMIT.

LANDSCAPE REQUIREMENTS

LOCATION	PLANTING YARD REQ'D	APPROX. LENGTH	CANOPY TREES	UNDERSTORY TREES	SHRUBS
FRANZ WARNER PARKWAY	STREETYARD	1,750'	35	-	298
PARKING LOT	1/2 SPACES	100 SPACES	8	-	-

PLANTING NOTES:

UNDERSTORY TREE SIZE: UNDERSTORY TREES MUST BE A MINIMUM OF FOUR FEET HIGH AND ONE INCHES IN CALIPER MEASURED SIX INCHES ABOVE GRADE, WHEN PLANTED.
CANOPY TREE SIZE: CANOPY TREES MUST BE A MINIMUM OF EIGHT FEET HIGH AND TWO INCHES IN CALIPER MEASURED SIX INCHES ABOVE GRADE, WHEN PLANTED. WHEN MATURE, A CANOPY TREE SHOULD BE AT LEAST FORTY FEET HIGH AND HAVE A MINIMUM CROWN WIDTH OF THIRTY FEET.
SHRUB SIZE: ALL APPROVED SHRUBS SHALL BE INSTALLED AT MINIMUM SIZE OF EIGHTEEN (18) INCHES, SPREAD OR HEIGHT, AND REACH A MIN. HEIGHT OF THIRTY-SIX INCHES AND A MINIMUM SPREAD OF THIRTY INCHES WITHIN THREE YEARS OF PLANTING.

PARKING AREA: ALL PLANTING AREAS WITHIN THE PARKING LOT MUST HAVE A MIN. 7' WIDTH AND 200 SF. ALL SPACES MUST BE WITHIN 100' OF A PARKING LOT CANOPY TREE.

EXISTING VEGETATION: THE EXISTING VEGETATION AT REAR OF PROPERTY IS TO REMAIN TO SATISFY TYPE 'D' PLANTING YARD REQUIREMENTS.

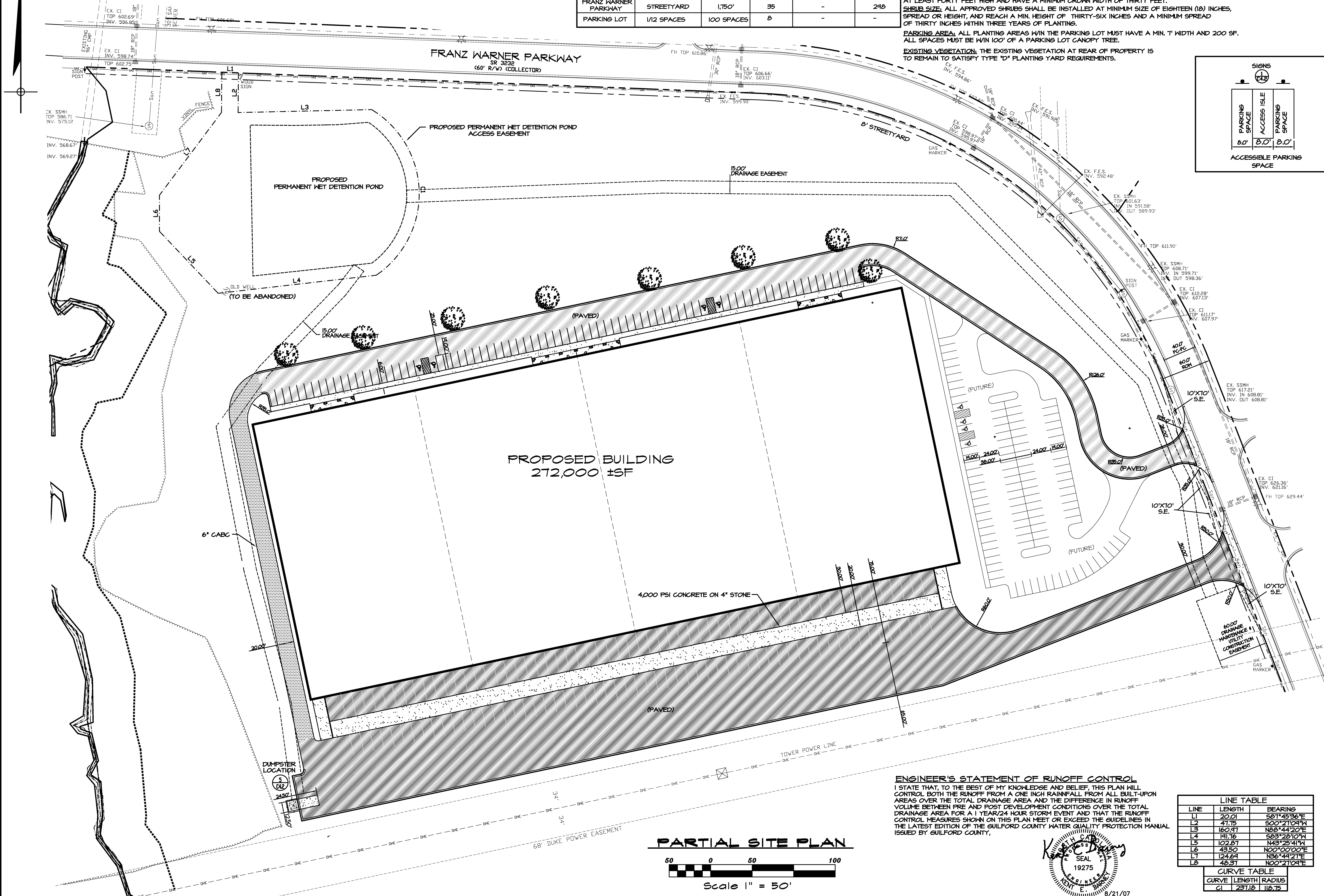
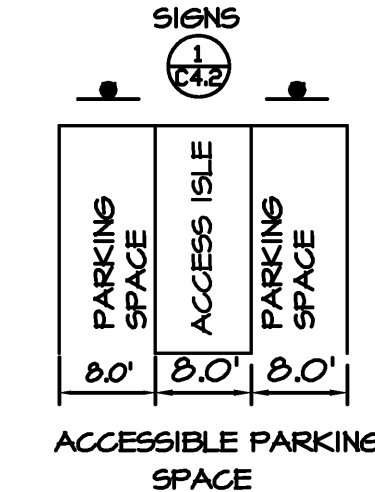

PROPOSED BUILDING
 272,000 ±SF

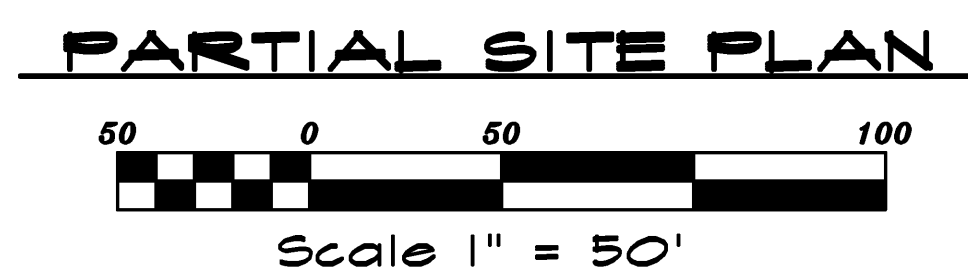

ENGINEER'S STATEMENT OF RUNOFF CONTROL
 I STATE THAT, TO THE BEST OF MY KNOWLEDGE AND BELIEF, THIS PLAN WILL CONTROL BOTH THE RUNOFF FROM A ONE INCH RAINFALL FROM ALL BUILT-UPON AREAS OVER THE TOTAL DRAINAGE AREA AND THE DIFFERENCE IN RUNOFF VOLUME BETWEEN PRE AND POST DEVELOPMENT CONDITIONS OVER THE TOTAL DRAINAGE AREA FOR A 1 YEAR/24 HOUR STORM EVENT AND THAT THE RUNOFF CONTROL MEASURES SHOWN ON THIS PLAN MEET OR EXCEED THE GUIDELINES IN THE LATEST EDITION OF THE GUILFORD COUNTY WATER QUALITY PROTECTION MANUAL ISSUED BY GUILFORD COUNTY.

LINE TABLE		
LINE	LENGTH	BEARING
L1	20.01	S07°45'36"E
L2	41.75	S00°21'04"W
L3	160.91	N88°44'20"E
L4	191.76	S83°22'10"W
L5	102.91	N43°28'41"W
L6	43.50	N00°00'00"E
L7	124.64	N86°44'21"E
L8	48.31	N00°21'04"E

CURVE TABLE		
CURVE	LENGTH	RADIUS
C1	237.18	118.75

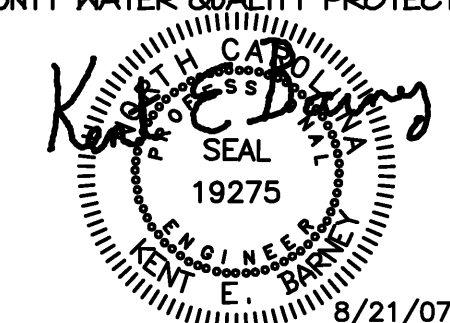

LANDMARK
 SURVEYING & MAPPING, INC.
 800-784-8000

PROPOSED BUILDING FOR
PROCC
 ROCK CREEK, GUILFORD COUNTY, N.C.

ENLARGE SITE PLAN

DATE: 8/21/07
 FILE: MANDL5855701 REG
 DRAWN BY: KEB
 REVISED:
 4/18/07
 5/21/07
 6/21/07
 6/21/07
 7/16/07
 8/21/07
 POND AND STORM DRAINAGE

JOB NO: JH-06118
 SHEET: **C14**